

July 2015

## Have your say – new traffic lights at the intersection of Westminster Street and Railway Terrace, Schofields

**The NSW Government is funding this proposal to improve travel times and safety.**

Roads and Maritime Services is seeking your feedback on new traffic lights at the Westminster Street and Railway Terrace intersection. This proposal aims to improve traffic flow and access to Westminster Street bridge and is part of the North West Growth Centre Road Network Strategy's short-term work. The Strategy was developed in response to existing congestion and to address future growth in the area. For more information about the North West Growth Centre Road Network Strategy, please visit [www.rms.nsw.gov.au/nwgc](http://www.rms.nsw.gov.au/nwgc)

The proposed traffic lights would make it easier for vehicles turning from Bridge Street onto Railway Terrace in peak times. We are also proposing to remove the right-turn from Railway Terrace into Westminster Street. This would reduce congestion for vehicles traveling northbound on Railway Terrace. Motorists would still be able to turn right at Kensington Park Road and St Albans Road as alternative routes.

The attached map helps to better explain the proposal. The work will include:

- Installing traffic lights at the intersection of Westminster Street and Railway Terrace
- Installing a 'No Right Turn' sign for traffic turning right from Railway Terrace into Westminster Street

The existing five tonne weight limit will remain on Westminster Street bridge.

### How can you give feedback?

We encourage you to send us your comments by **Monday 24 August** to:

Riverstone NWGC  
Roads and Maritime Services  
PO Box 973  
Parramatta CBD NSW 2124

or

[RiverstoneNWGC@rms.nsw.gov.au](mailto:RiverstoneNWGC@rms.nsw.gov.au)

We will carefully consider your feedback and continue to keep you updated as the project progresses.

---

## Field investigations

Roads and Maritime will be carrying out field investigations to help us develop the proposed traffic light design. The investigation will include some survey work and minor excavation.

This work will be carried out from **Monday 3 August** until **Monday 5 October** excluding weekends, weather permitting. Our working hours will be **7pm to 6am**.

## Traffic changes

There will be some temporary traffic changes to make sure the work zone is safe. Lane closures will be in place and may affect travel times. Please keep to speed limits and follow the direction of traffic controllers and signs. For the latest traffic updates, you can call 132 701, visit [livetraffic.com](http://livetraffic.com).



### Proposed changes to the Westminster Street and Railway Terrace intersection

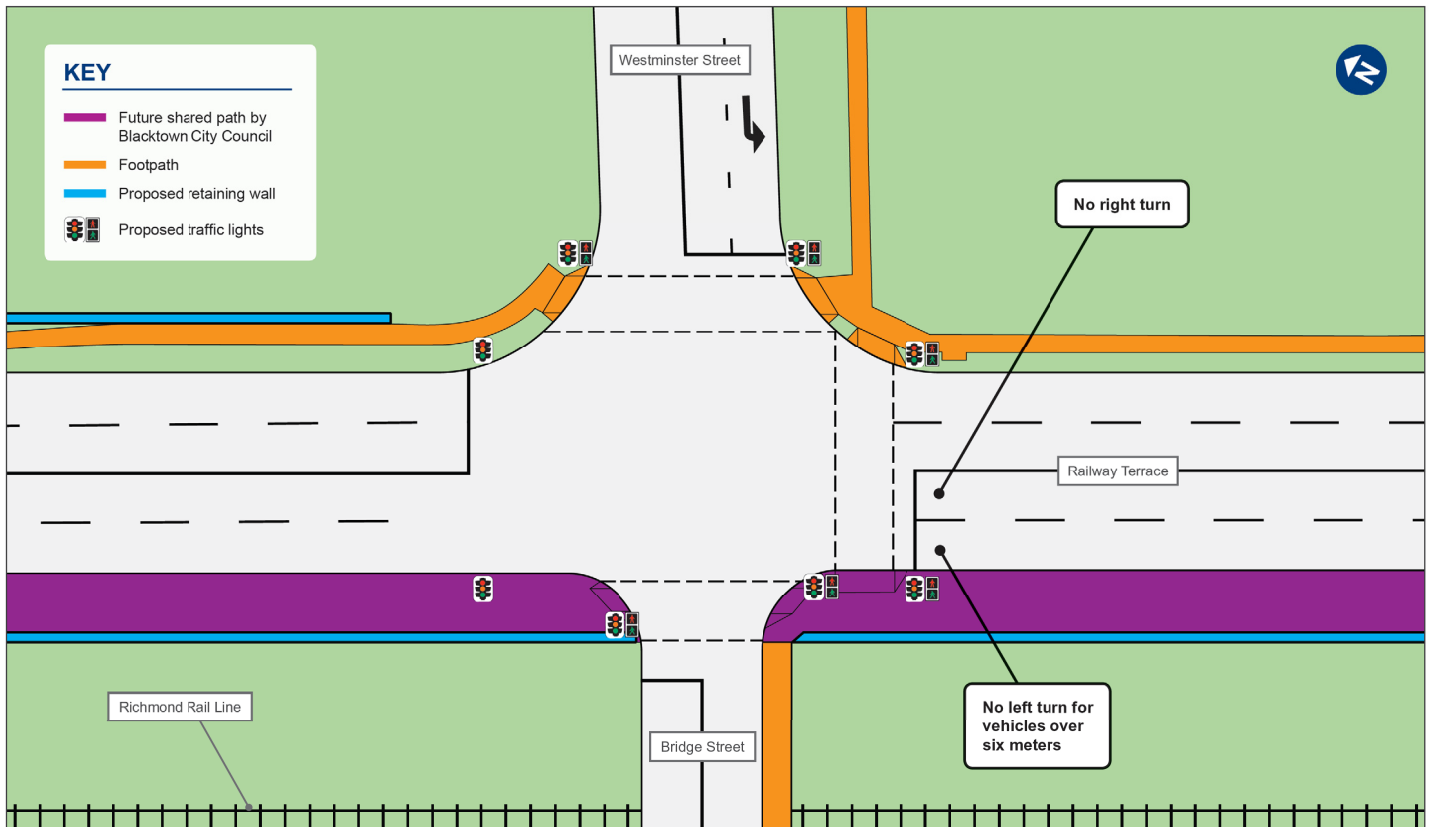

## Contact

If you have any questions, please contact our Project Engineer on 02 8849 2991 or email [ari.sitinamaluwe@rms.nsw.gov.au](mailto:ari.sitinamaluwe@rms.nsw.gov.au) For more information on our projects, visit [rms.nsw.gov.au](http://rms.nsw.gov.au)