

LEGEND

- Road pavement 1
- Road pavement 2
- Road pavement 3
- Road pavement 4
- Road pavement 5

Pavement Type 1
MAINLINE RIGID PAVEMENT
 Scale 1:10

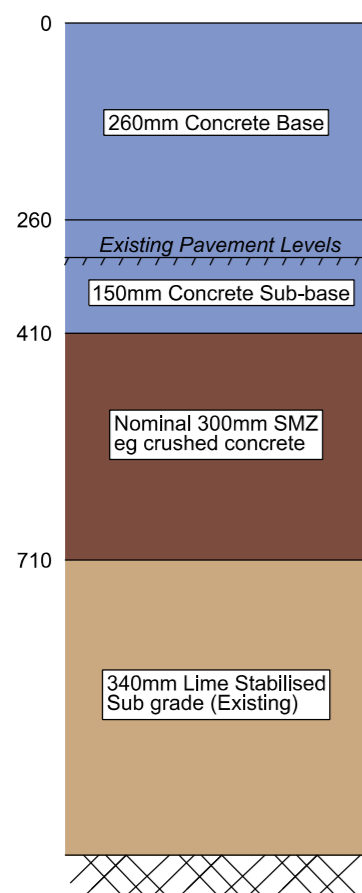

Pavement Type 2
MAINLINE FLEXIBLE PAVEMENT
 Scale 1:10

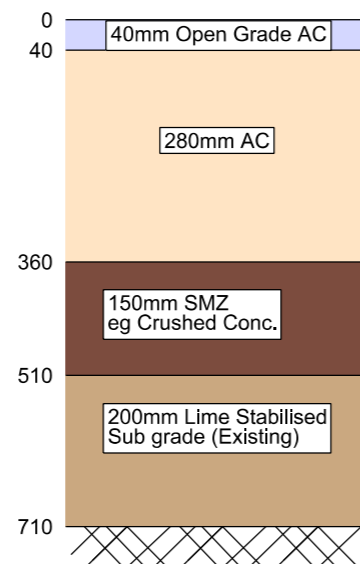

Pavement Type 3
OTHER FLEXIBLE PAVEMENT
 Scale 1:10

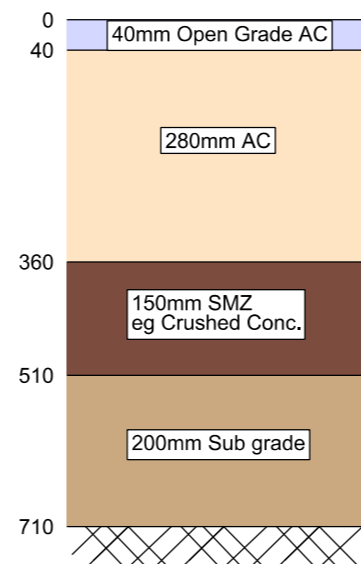

Pavement Type 4
ASPHALT RESHEET
 Scale 1:10

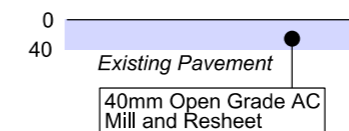

Pavement Type 5
TEMPORARY PAVEMENT
 Scale 1:10

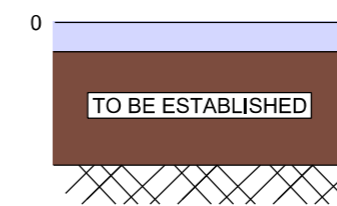

NOT FOR CONSTRUCTION

A3 ORIGINAL 125mm ON ORIGINAL

ISSUE	DATE	ISSUE / AMENDMENT DESCRIPTION
1	10.01.2014	ISSUED FOR DISCUSSION

This sheet may be prepared using colour and may be incomplete if copied

<p>SCALES</p> <p>SCALE 1:10m</p>	<p>NSW GOVERNMENT</p> <p>Transport Roads & Maritime Services</p> <p>PREPARED BY:</p>
----------------------------------	---

NSW GOVERNMENT

Transport
Roads & Maritime Services

PREPARED BY:

HILLARD CIVIL

PRODUCED: 10/01/2014 10:46:51 AM

ROADS AND MARITIME SERVICES

M1 PACIFIC MOTORWAY
 PROVISION OF THIRD TRAVEL LANE BETWEEN
 TUGGERAH INTERCHANGE AND DOYALSON INTERCHANGE
 CH85000 TO CH96580 NORTH OF SYDNEY
 PAVEMENT DETAILS

DRAWING SK008.dgn	STAGE STRATEGIC	PART No. -	ISSUE -
REGISTRATION NUMBER SK008		SHEET No. SK008a	

FLEXIBLE PAVEMENT - WIDENING (South of Wyong River)

- Notes:
1. Contraflow posted speed max. 80km/h
 2. Wire rope mounted in linear concrete slab 1m wide at 0.5m offset to carriageway pavement.

LEGEND

- Road pavement 1
- Road pavement 2
- Road pavement 3
- Road pavement 4
- Road pavement 5

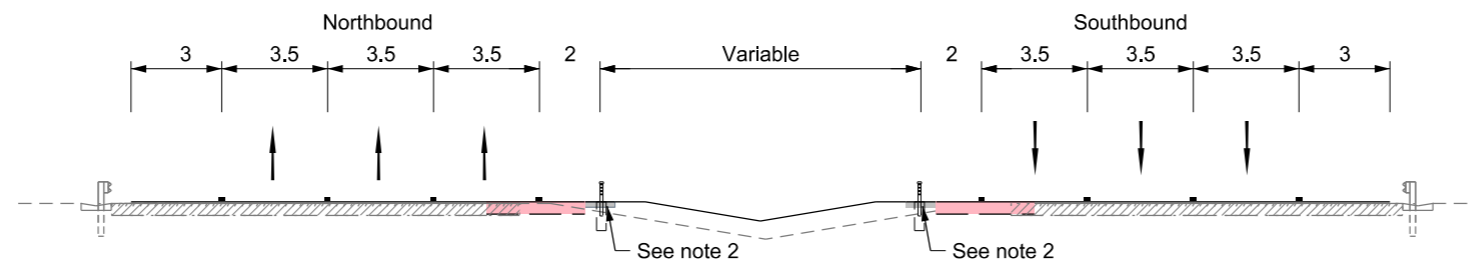
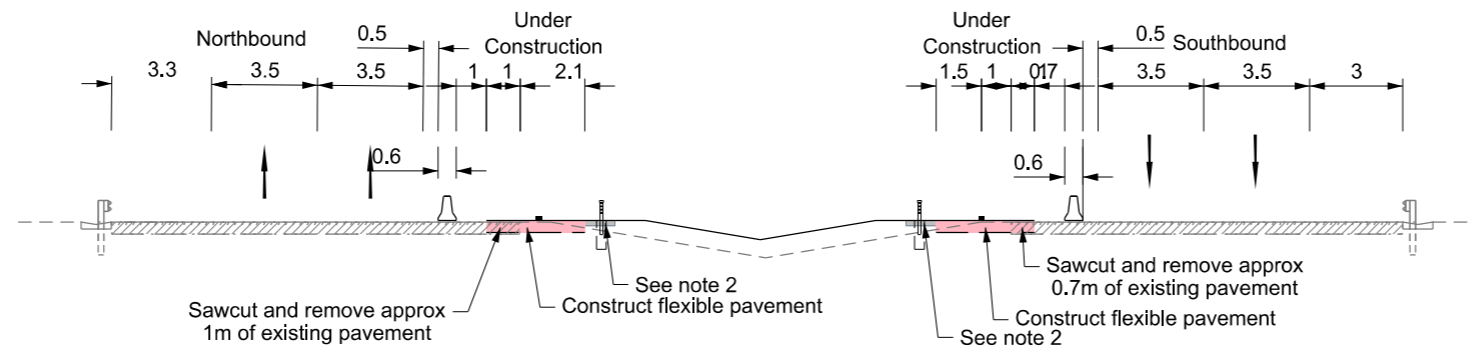

NOT FOR CONSTRUCTION

A3 ORIGINAL 1:25mm ON ORIGINAL

ISSUE	DATE	ISSUE / AMENDMENT DESCRIPTION
1	10.01.2014	ISSUED FOR DISCUSSION

This sheet may be prepared using colour and may be incomplete if copied

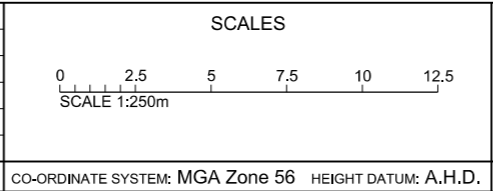

Transport
 Roads & Maritime
 Services
PREPARED BY:

PRODUCED: 10/01/2014 10:46:51 AM

ROADS AND MARITIME SERVICES

M1 PACIFIC MOTORWAY
 PROVISION OF THIRD TRAVEL LANE BETWEEN
 TUGGERAH INTERCHANGE AND DOYALSON INTERCHANGE
 CH85000 TO CH96580 NORTH OF SYDNEY
 CONSTRUCTION STAGING - FLEXIBLE PAVEMENT

DRAWING SK008.dgn	STAGE STRATEGIC	PART No. -	ISSUE -
REGISTRATION NUMBER		SHEET No.	
SK008		SK008b	

RIGID PAVEMENT - FULL RECONSTRUCTION (North of Wyong River)



EXISTING

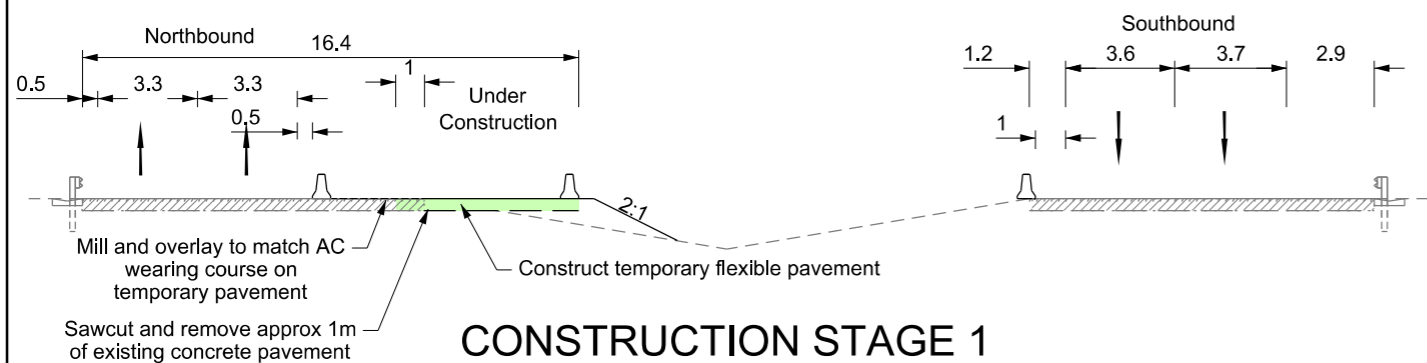

CONSTRUCTION STAGE 1

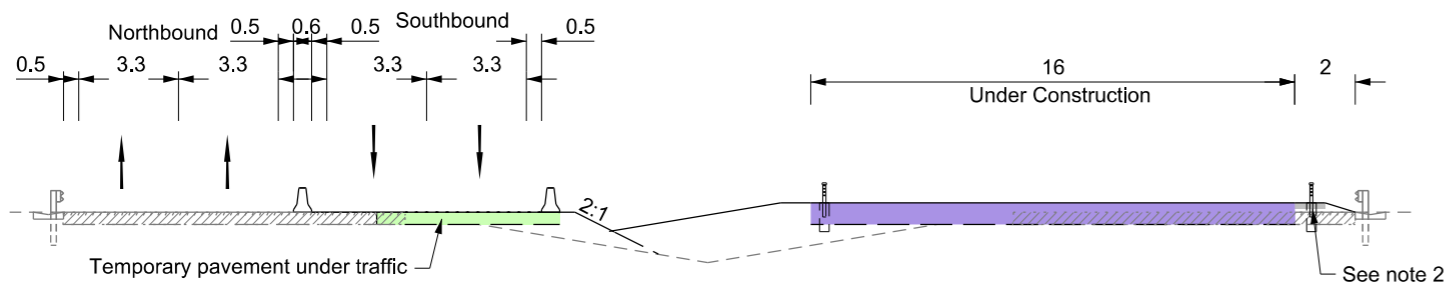

CONSTRUCTION STAGE 2

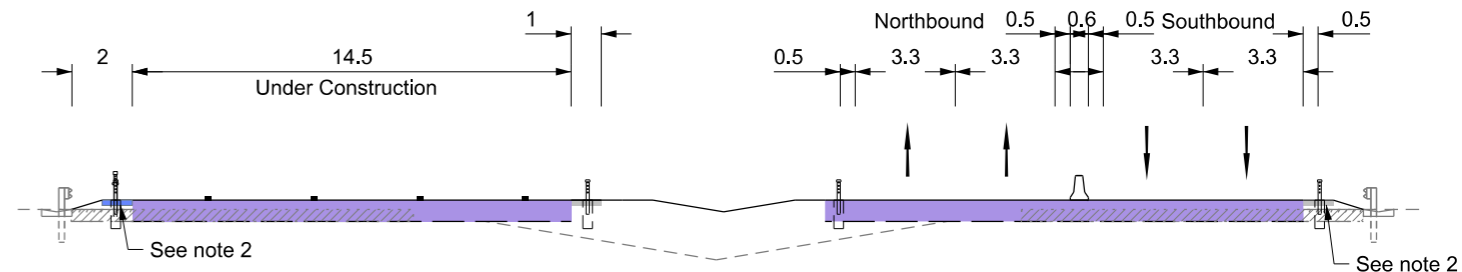

CONSTRUCTION STAGE 3

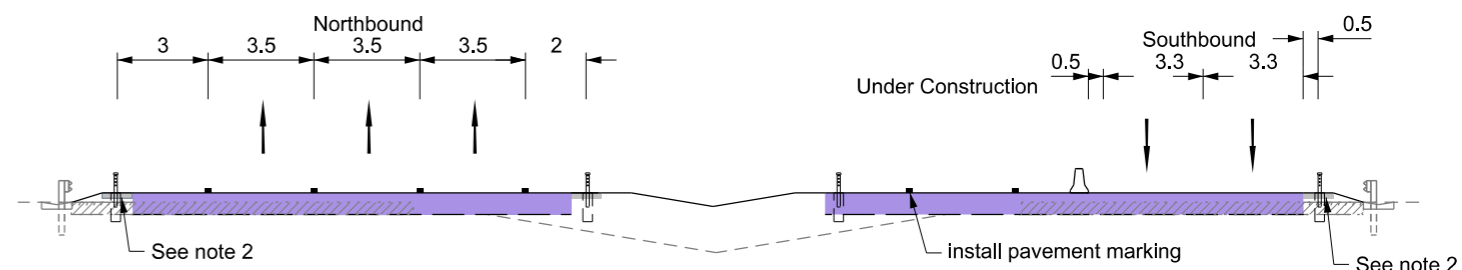

CONSTRUCTION STAGE 3a

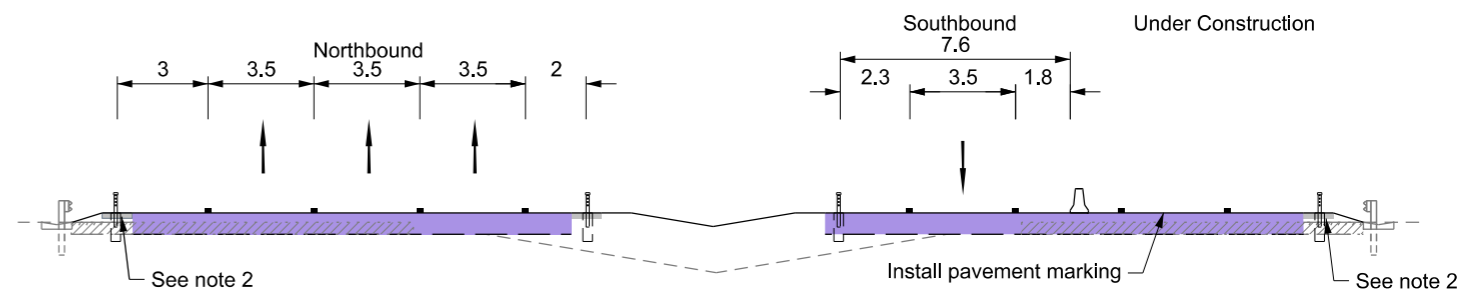

CONSTRUCTION STAGE 3b

NIGHT WORKS ONLY

Note:
Southbound carriageway reduced to 1 travel lane in construction stage 3b and therefore only only feasible as night works.

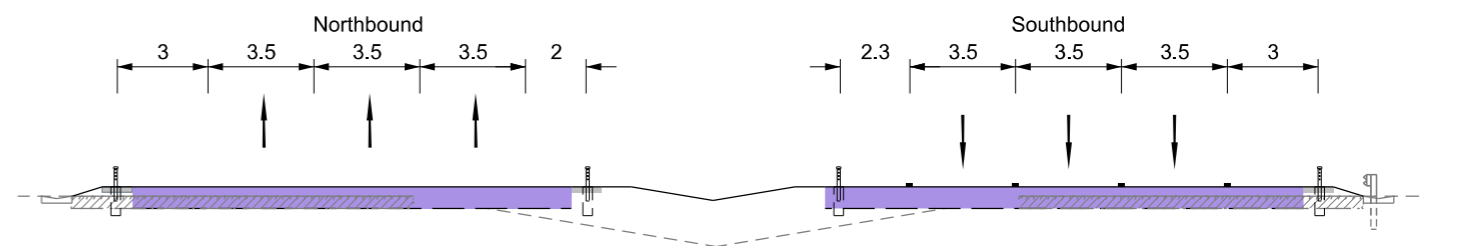

ULTIMATE

- Notes:
1. Contraflow posted speed max. 80km/h
 2. Wire rope mounted in linear concrete slab 1m wide at 0.5m offset to carriage way pavement.

LEGEND

- Road pavement 1
- Road pavement 3
- Road pavement 5
- Road pavement 2
- Road pavement 4



NOT FOR CONSTRUCTION

1:25mm ON ORIGINAL

ISSUE	DATE	ISSUE / AMENDMENT DESCRIPTION
1	10.01.2014	ISSUED FOR DISCUSSION

This sheet may be prepared using colour and may be incomplete if copied

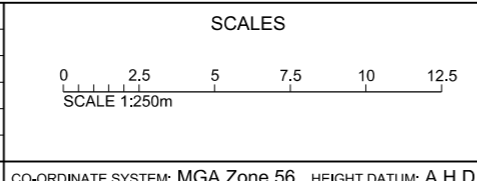

Transport
Roads & Maritime
Services

PREPARED BY:
HILLARD CIVIL

PRODUCED: 10/01/2014 10:46:51 AM

ROADS AND MARITIME SERVICES

M1 PACIFIC MOTORWAY
PROVISION OF THIRD TRAVEL LANE BETWEEN
TUGGERAH INTERCHANGE AND DOYALSON INTERCHANGE
CH85000 TO CH96580 NORTH OF SYDNEY
CONSTRUCTION STAGING - RIGID PAVEMENT

DRAWING SK008.dgn	STAGE STRATEGIC	PART No. -	ISSUE -
REGISTRATION NUMBER SK008		SHEET No. SK008c	