

July 2022

Barton Highway upgrade

Temporary traffic changes at Rolfe Road

The Australian and NSW governments are investing in the Barton Highway upgrade to improve safety and journey reliability for all road users, ease congestion and boost freight productivity.

What are we doing?

Work is progressing on the new two-lane northbound carriageway for the first stage of the Barton Highway upgrade. As part of this upgrade, we are upgrading the Rolfe Road intersection. The intersection will be moved from the current location to a new alignment about 30 metres north. This will allow the completion of intersection work, improving access and safety.

As we build this new intersection, work will include removal of the existing road and building the new road to the final design including general earthworks, road surface construction, sealing, kerb and guttering, drainage work and installation of road fixtures.

When are we working?

Work will be carried out from **Monday 11 July** and is expected to be completed by mid-2023, weather permitting. Further information will be provided about traffic changes at the intersection as work continues over the coming months.

Our work hours are between **7am** and **6pm** from **Monday** to **Friday** and **8am** and **1pm** **Saturday, excluding public holidays.**

There may be a need to carry out some work at night to reduce impacts on traffic. Nearby residents will be notified in advance of this work.

How will the work affect you?

Work will involve the use of machinery that will generate some noise. We will make every effort to minimise noise by arranging the work in stages at different locations and turning off machinery and vehicles when not in use.

There will be temporary traffic changes during work hours to ensure the work zone is safe for both residents and workers. Traffic will be switched onto a new and temporary road surface while we build this new intersection.

Resident access will be maintained while this work is carried out.

A map showing the work areas is provided over the page.

Traffic changes

Lane closures, traffic control and reduced speed limits will be in place during work hours and may affect travel times. Motorists are advised to allow up to five minutes extra travel time to their journey while work is under way.

Please keep to speed limits and follow the direction of traffic controllers and signs. For the latest traffic updates, you can call **132 701**, visit **livetraffic.com** or download the **Live Traffic NSW App**.

We apologise for any inconvenience and thank you for your patience during this important work.

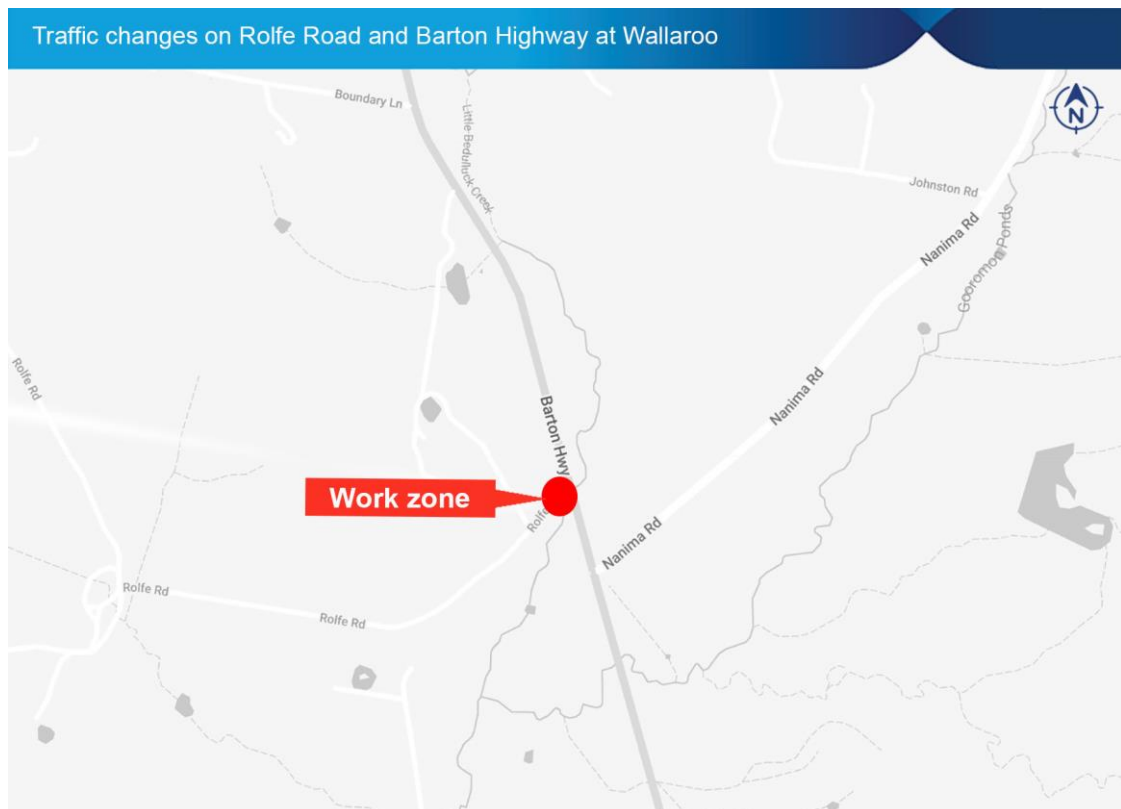

Contact

If you have any questions, please contact our project team:

Phone: 1800 931 250

Email: barton.highway@transport.nsw.gov.au

Website: rms.nsw.gov.au/projects/barton-highway



If you need help understanding this information, please contact the Translating and Interpreting Service on 131 450 and ask them to call 1800 931 250.