

NOTES

1. ALL WORK TO BE DONE IN ACCORDANCE WITH SPECIFICATION P/6.
2. REMOVE ALL BURRS & SHARP EDGES FROM HOLES. THE SURFACE OF TUBULAR SECTION SHALL BE SMOOTH & FREE FROM DAGS OR SHARP PROJECTIONS CAUSED BY THE GALVANISING PROCESS.
3. MANUFACTURERS IDENTIFICATION & DATE OF MANUFACTURE SHALL BE LEGIBLY AND DURABLY MARKED.
4. ALL THREADS TO BE CLEARED AFTER GALVANISING.

ITEM	DESCRIPTION	MATERIAL	FINISH	QTY	REMARKS
3	DOME 3mm THICK	MS GRADE 250	HOT DIP	1	
2	BASE PLATE	MS GRADE 250	GALVANISED	1	TO AS 2338
1	100 NB PIPE, MEDIUM	STEEL	TO AS 1650	1	TO AS 1074

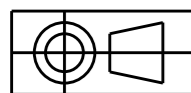

DIMENSIONS IN MILLIMETRES

A ORIGINAL ISSUE
 B ISSUE 2003-11-12
 4 HOLES IN ITEM 2
 WERE Ø20. RADIUS WAS
 10 IN DETAIL A.
 IH BT
 C ISSUE 20-09-12.
 2x M10 TAPPED HOLES
 NOTE 4 ADDED.
 LC BWT

REFERENCE DRAWINGS	
FOOTING	VC002-66
HOLDING DOWN BOLT	VC002-67
ADAPTOR PLATE	VM202-21
SUPPLY CAT NO. 18233992	

ROADS AND TRAFFIC AUTHORITY OF NSW
 TRAFFIC SIGNALS
TYPE 13 PUSH BUTTON POST
 (TO SUIT 200mm PCD HOLDING
 DOWN BOLT CENTRES)

SCALE	
1:10	OR AS SHOWN
SUPERSEDES:	
DRAWN	G.BRENNAN 7-3-03
CHECKED	I. HAYES 11-3-03
PASSED	B. TAYLOR 2003-03-11

APPROVED: 2003-03-11	
S. SRIVASTAVA MANAGER STANDARDS & QUALITY	
ISSUE	A B C
VM202-20	