

SIDE VIEW  
(DETAIL ASSEMBLY)

NOTES

1. DEBURR AND REMOVE SHARP EDGES AND CORNERS.
2. ALL ITEMS SHALL BE SUPPLIED AND FULLY ASSEMBLED (AS SHOWN) BY THE MANUFACTURER.
3. THE SPECIAL LOCK WASHER (ITEM 6) TO BE FITTED TO THE STRAP WITH THE STANDARD LOCK WASHER (ITEM 5), DIMPLE TO DIMPLE.
4. LOCK WASHERS TO BE MANUFACTURED TO RTA PLANS VM200-24 AND VM200-29.
5. TOLERANCE:  $\pm 1\text{mm}$

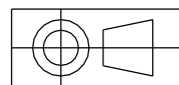

DIMENSIONS IN MILLIMETRES

ITEM	DESCRIPTION	MATERIAL	FINISH	QTY
6	SPECIAL LOCK WASHER (SEE PLAN VM200-29)	STAINLESS STEEL	BLACK	1
5	STANDARD LOCK WASHER (SEE PLAN VM200-24)	STAINLESS STEEL	NATURAL	1
4	HEXAGON HEAD NUT M12 TO AS 1112	MILD STEEL	GALVANISED TO AS 1214	2
3	HEXAGON HEAD BOLT M12 X 50 TO AS 1111			1
2	FLAT WASHER M12 LARGE SERIES TO AS 1237		GALVANISED TO AS 4680	2
1	STEEL FLAT BAR 40 X 5 TO AS 3679			1

A ORIGINAL ISSUE	REFERENCE DRAWINGS		ROADS AND TRAFFIC AUTHORITY OF NSW TRAFFIC SIGNALS	SCALE 1 : 2		APPROVED: 03-05-99 T YUNG	
	ASSEMBLY DETAILS	VM200-27		SUPERSEDES:		MANAGER EQUIPMENT & STDS	
	STD LOCK WASHER	VM200-24	DRAWN			RVC 20-04-99	ISSUE
	SPECIAL LOCK WASHER	VM200-29	CHECKED	BWT 30-04-99	VM012-14		
	TEE-BAR 300mm LANT	VM012-15	PASSED	B TAYLOR 30-04-99			
RTA CAT NO 18230543		TEE-BAR STRAP FOR DUAL 200mm LANTERNS					